

LWPAC

Lang Wilson Practice in Architecture Culture



MOORE ARCHITECTURE INC.

March 14, 2014

The Art Gallery of Greater Victoria has selected

LWPAC Lang Wilson Practice in Architecture Culture Inc. + Moore Architecture Inc. (MA) Associated Architects, as the architects for the major additions and renovations for the future home of the Gallery at its current location at 1040 Moss St, Victoria, BC.

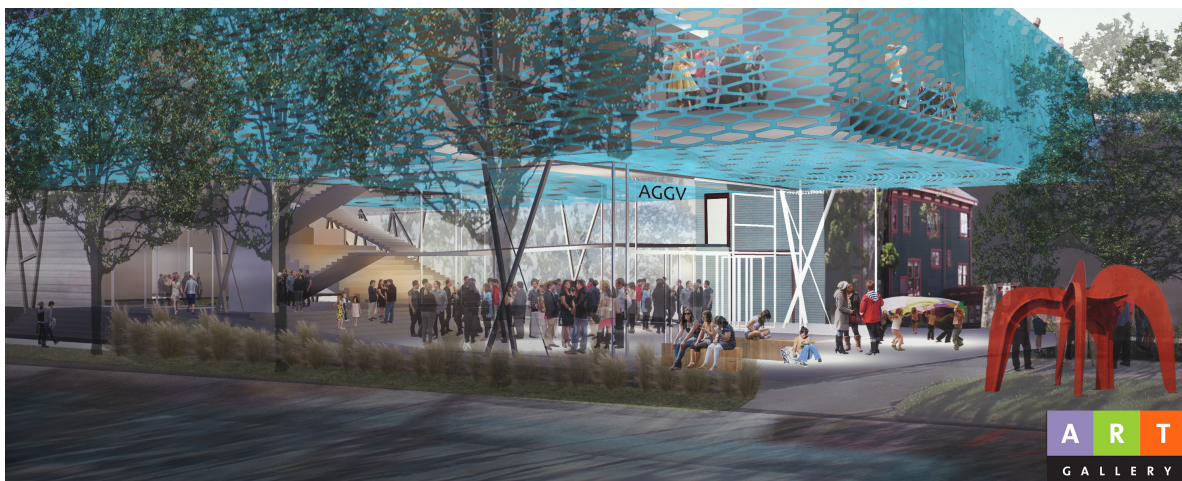

LWPAC+MA was selected as the winner from an internationally open request for proposals and subsequent design concept submissions from 3 shortlisted firms. The project has a budget of \$21,000,000 and it is slated for completion in the fall of 2017.

The AGGV holds the largest public art collection in Western Canada with over 18,000 works of art, ranging from Contemporary, Asian, New Media and Native Art collections to a dedicated Emily Carr gallery. The AGGV has been Greater Victoria's mayor art centre and museum since 1951.

LWPAC+MA have formed a highly integrated architectural team to provide the AGGV with a full range of resources, skills, experience and services that this complex project will require. Both firms will collaborate on all aspects of the project. LWPAC is the Lead Design Architect and will manage the project as the Architect of Record, while MA is contributing its local experience based on major projects in Victoria and their understanding of approval processes, heritage alterations and construction procurement.

LWPAC: 3353 West 4th Avenue | Vancouver BC | V6R 1N6 | p: 604.737.7600 | e: office@lwpac.net
MA: 531 Herald Street | Victoria BC | V8W 1S5 | p: 250.384.2131 | e: info@moorearchitecture.ca



Lang Wilson Practice in Architecture Culture



MOORE ARCHITECTURE INC.

LWPAC, based in Vancouver British Columbia since 1999, is an interdisciplinary architecture and design practice with projects completed in Canada, China, the USA and Chile. The firm has won national and international architecture design awards including a Governor General's Medal Award of Excellence, Lieutenant Governor's Medal, two AIBC Innovation Awards, Design Exchange Award, Canadian Wood Council BC Award and New York based Architect's Home of the Year Award. LWPAC had a solo exhibition at the Vancouver Art Gallery and was selected as "New Vanguard" by Architecture Record. In 2012 LWPAC won the Western Living Designer / Architect of the Year award. The work has been published extensively around the world. LWPAC is led by German born architect Oliver Lang, Architect AIBC, and Canadian Cynthia Wilson. They met in Barcelona in 1990 while studying architecture. The partners were trained in Berlin, Barcelona and New York City and received professional degrees in architecture and advanced design from Columbia University and the TU Berlin (Oliver) and UBC (Cynthia). Oliver has served consistently on several faculties including professorships at SCI ARC, the Berlage, UBC, UPenn and held design instructor positions at Princeton and Columbia Universities. He is the recipient of an ACSA Faculty Design Award. He has been Acting Chair of the Vancouver Urban Design Panel and continues to serve on various other advisory design panels. Prior to LWPAC, he was a Chief Design Architect for the Corning Glass Museum at Smith-Miller + Hawkinson Architects in New York City. Cynthia has been appointed Adjunct Professor at UBC's SALA in 2013, and had previously worked at Zeidler-Roberts Partnership and Selldorf Architects.

Moore Architecture Inc., based in Victoria British Columbia, was formed by Tom Moore, Architect AIBC, in 2012 to build on his 25 plus years of work on Vancouver Island as a Principal and Architect with Moore Paterson Architects Inc. and Stantec Architecture Ltd. He is the Designer and Architect on numerous award winning projects. Awards include AIBC Lieutenant Governor's Award of Merit, numerous Heritage Society of British Columbia awards, and Hallmark Society awards. Projects include the Victoria International Airport additions and renovations voted by CNN GO as one of the top ten Airport terminals in the world (#8), Saanich Commonwealth Place, adaptive reuse of heritage buildings such as Dragon Alley, the Monaco, and the Crystal Gardens (Victoria Conference Centre), additions and renovations to the Oak Bay Recreation Centre and Vancouver Island Visitor Centre in the Comox Valley. He has been involved in a broad range of community related activities including a Member of the Victoria Civil Heritage Trust Board and Architectural Conservation Committee, the Victoria Cool Aid Society Board (past Chair), the City of Victoria Urban Design Panel (past Chair) and Victoria Airport Authority and Oak Bay Recreation Commission Public Art Committees.

LWPAC: 3353 West 4th Avenue | Vancouver BC | V6R 1N6 | p: 604.737.7600 | e: office@lwpac.net
MA: 531 Herald Street | Victoria BC | V8W 1S5 | p: 250.384.2131 | e: info@moorearchitecture.ca